

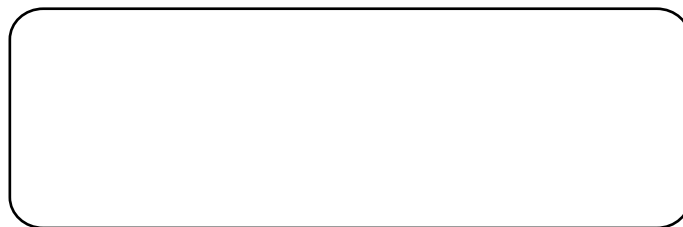

INSTALLATION GUIDE

It is recommended that you have your
HID kit installed by a professional.

Contact & Technical support



Please read installation guide completely before installing.
Check local laws regarding the use of HID lights.
This product is intended for off road use only.

copyright 2008 Launch Technology Group inc.

Certifications



Thank you for choosing GT HID. Please read all the safety and operating instructions before installing your HID kit to avoid personal injury and damage to the HID system.

Important Safety Instructions

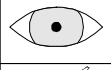
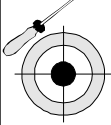
	<ul style="list-style-type: none"> • Do not touch the HID bulb. If you touch the bulb during install, clean with alcohol.
	<ul style="list-style-type: none"> • Do not look directly into bulb when it is turned on as it may cause permanent damage to your eyes.
	<ul style="list-style-type: none"> • Headlights must be adjusted after installation. HID bulbs are much brighter than halogen bulbs. By not adjusting your headlights, you may reduce the visibility of oncoming traffic. If you do not know how to adjust your headlights, please consult a professional.

- Retain instructions for future reference and warranty.
- Do not drop or apply unreasonable force to your HID components as it may damage them. If damage is discovered, discontinue use and contact your retailer. Do not use the system until the problem is solved to avoid electric shock or fire.
- This equipment generates 20,000 volts when activated. Do not use wet or oily hands when installing or inspecting the system. Doing so may cause serious burns or electric shock.
- Make sure connectors and wires are secure and away from any hot surfaces. Wires that are loose or resting against a hot surface may cause an electrical hazard.
- Do not turn lights on/off rapidly. Doing so may reduce the life span of your bulbs and cause discoloration.
- Do not install HID in any housing with cracks, moisture may damage bulbs or cause shock.
- Daytime Running Lights on some vehicles cause problems with the HID ballasts, if you disable the factory DRL system, make sure to replace it via alternative means, e.g. a relay on the lowbeams switched by an ign source.

Components

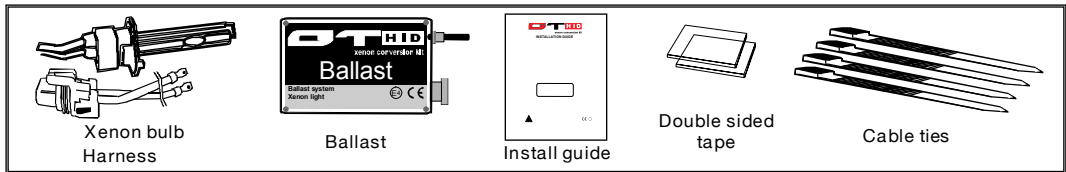

Pre test Before Install

Before you install your HID kit, ensure compatibility by plugging in all the wires and turning the system on (refer to the diagrams on page 2).

If you experience any problems, refer to our FAQ guide at the back of this book.

- When checking for DRL issues, remember to release park break with a manual transmission. For automatic vehicles, put the vehicle in first gear prior to testing.
- If the bulbs flicker during the test then turn them off immediately. Continued use will damage the bulb. Disable the day time running light system by removing the DRL relay or DRL fuse. Some vehicles will require a DRL/relay harness to disable DRL systems.

Advanced installs should be done by a professional. Installs requiring DRL bypasses, computer bypasses or resistors are not covered in this manual. If attempting such installs, it is important to note that:

- Capacitor / BMW harness are polarity sensitive.
Yellow wire = Positive (+) Blue wire = Negative (-) *connected backwards could explode the capacitor.
- 25W or 50W resistor harnesses become extremely hot (160c) during operation. They should be isolated, hung between two points, and should not come in contact with anything other than metal.

Wiring, relays & fitment

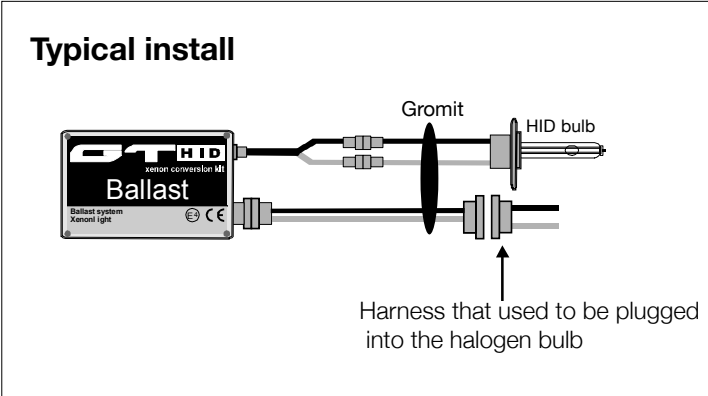

Aftermarket projectors (H1 only)

Rear View of H1 Socket Headlight Housing

If HID bulb is slightly bigger than the halogen bulb socket, file the shaded area according to the picture. Use a file to increase hole to 12 mm.

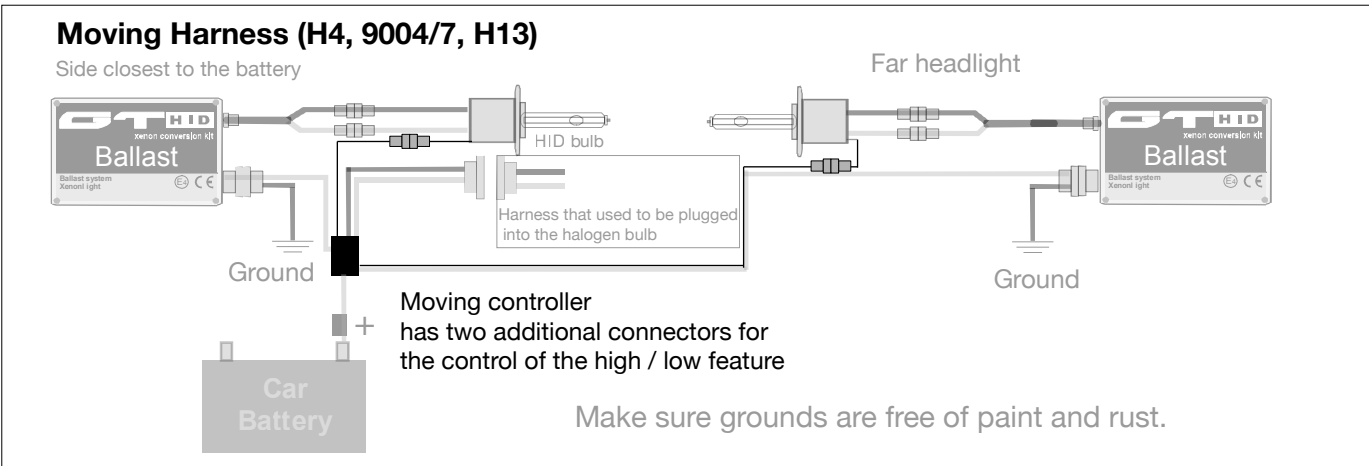
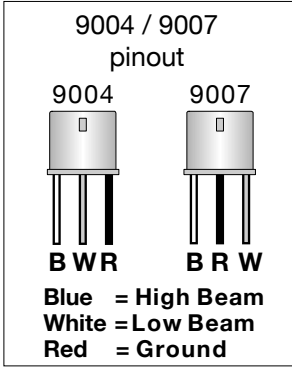
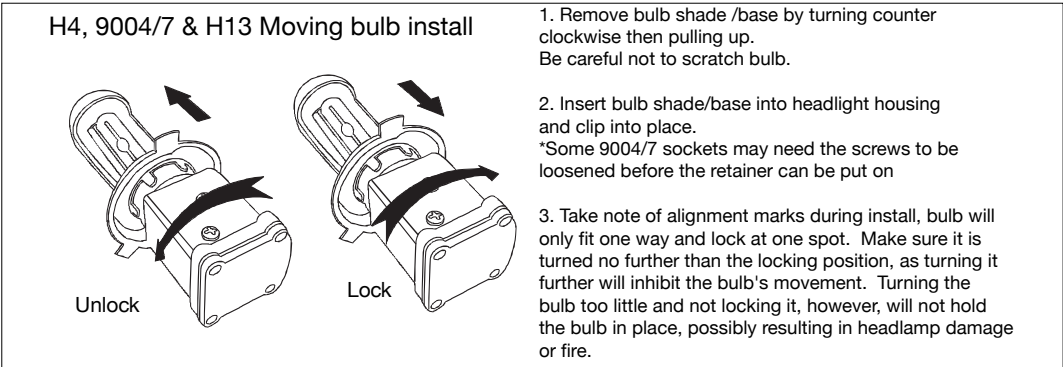
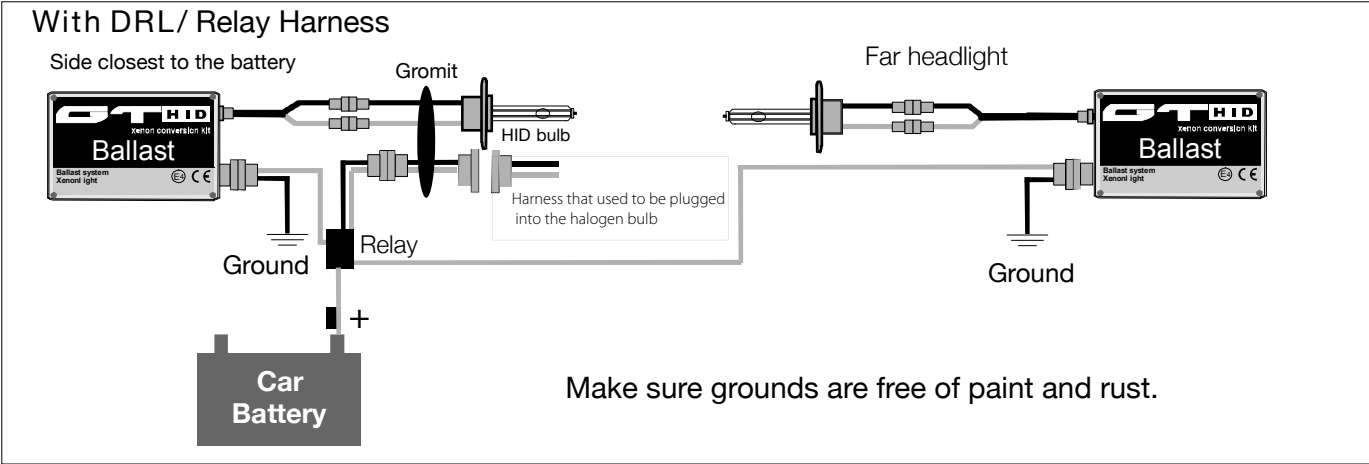

Frequently Asked Questions

Q: After installation, my kit does not turn on. If I connect it straight to the battery, it works. Why is that?

A: Some vehicles are wired backwards. With a halogen bulb it doesn't matter which way the power is connected, either negative to positive or vice versa, because it has a filament. An HID kit, however, can only be connected one way. Simply flip the plug that powers the ballast. Connecting the ballast backwards will not damage the unit.

Q: I start my car with the HID kit turned on and one or both of the lights turn off.

A: The lack of power and pulsing voltage when your starter is cranking may activate the safety circuit in the ballast and turn one or both off to protect itself.

Solution: a. Start car with headlights turned off
b. Install a relay harness to supply more power

Q: Does my car require a DRL (day time running light) harness?

A: 1) If your DRL and your low beam are the same bulb it may only output 50% to 80% power when your DRL is active and will cause your lights to flicker.

That lack of power is not enough to activate the HID ballast.

In some vehicles, you can remove the DRL relay or fuse to disable your DRL. aka. DTRL

This will stop your lights from flickering when you start your car.

If the fuse or relay is not present, a relay can be installed to bypass it.

Troubleshooting Guide

Issue: The lamp does not light up.

Solution: Check if all sections are secure, and inside the connector have no bent pins. Use a multi meter to test if polarity and the connections of the wires are correct and that you are getting 12V

Issue: One lamp off or is flickering.

Solution:

- 1) Disconnect the power then swap the bulb or ballast to the other side of the vehicle to see where the problem lies.
- 2) You may need an Relay harness, as your factory wires are insufficient gauge, and do not have enough power to turn on both lamps at the same time.
- 3) Check ground points to make sure they are free of paint and rust, Poor grounds are commonly responsible for malfunction

*If no solutions are found a relay can be installed and the activation switch for the relay can be wired to the vehicles ignition or to a manual toggle switch (thus bypassing the headlight switch and any problem circuit completely.)

If the above method doesn't work, apply power directly to the ballast without going through the harness to see if the problem lies in the vehicle or harness

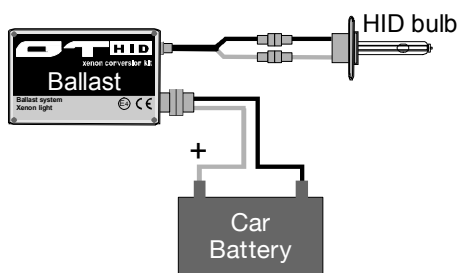

Basic Temporary adjustment

- 1) Park on a level surface 20 feet behind another car and turn on your headlights.
- 2) Make sure the cut off of the beam is just above the bumper on the car in front (please refer to bottom image).
- 3) To make sure the headlights are evenly adjusted, you should point your car at a flat wall about 20 feet away and adjust the lights so they line up.

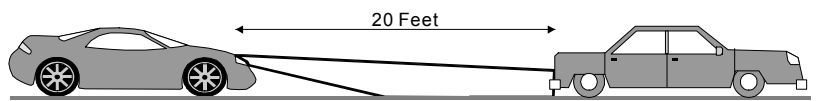

There are lots of resources online to help you aim your own headlights

We recommend you have your HID kit installed and adjusted by a professional for best performance